

SANITARY SEWER NOTES:
 STA 0+20.00 - CL
 MH#1
 CONNECT NEW 24" PVC
 SANITARY SEWER MAIN INTO
 EXISTING MANHOLE

STA 2+38.78 - CL
 MH#2
 8" MANHOLE
 N=8232.15
 E=4213.06

STA 2+71.00 CL TO
 4+50.00 - CL
 LAY & BORE 30"
 STEEL SLEEVE - 179'LF

STA 4+55.91 - CL
 MH#3
 8" MANHOLE
 N=8012.93
 E=4146.42

STA 5+31.44 - CL
 MH#4
 REMOVE EXISTING MANHOLE
 CONNECT TO EXISTING
 SANITARY SEWER

MISCELLANEOUS NOTES:
 STA 2+08.48 - 20' L&R
 REMOVE & RESET BARBED WIRE FENCE

STA 2+28 - 6' L&R TO 2+49 - 6' L&R
 SAWCUT ASPHALT PAVEMENT - 48' #
 REMOVE ASPHALT PAVEMENT - 31.15 #
 AGGREGATE BASE COURSE, 12" - 19.6 #
 5" ASPHALT CONCRETE PAVEMENT, CLASS G, TYPE 1 - 8.8 #

MISCELLANEOUS NOTES:
 STA 2+08.48 - 20' L&R
 REMOVE & RESET BARBED WIRE FENCE

STA 4+78 - 6' L&R TO 5+38 - 6' L&R
 SAWCUT ASPHALT PAVEMENT - 132' #
 REMOVE ASPHALT PAVEMENT - 81 #
 AGGREGATE BASE COURSE, 12" - 51.0 #
 5" ASPHALT CONCRETE PAVEMENT, CLASS G, TYPE 1 - 21.2 #

STA 2+50 - CL
 CONSTRUCT TRENCH CHECK DAM

STA 4+72 - 4.5'R
 REMOVE AND RESET SIGN

CITY OF RAPID CITY
 GROWTH MANAGEMENT DEPT.
 DEVELOPMENT SERVICES

Plans are reviewed for general conformance with applicable governmental regulations, stipulations, design criteria and engineering standards. The City of Rapid City does not certify the suitability, adequacy or completeness of the plans or design, which are the responsibility of the engineer of record. All necessary permits shall be obtained prior to construction of the proposed public improvements.

Engineering Reviewer: _____ Date: _____

COMMENTS

DREAM DESIGN INTERNATIONAL, INC.
 PROFESSIONAL STRUCTURAL & CIVIL ENGINEERING CONSULTANTS
 528 KANSAS CITY ST., SUITE 4, RAPID CITY, SD 57701
 PH: 605-348-0538 FAX: 605-348-0545 EMAIL: eng@dreamdesigninc.com

PRELIMINARY FOR REVIEW ONLY

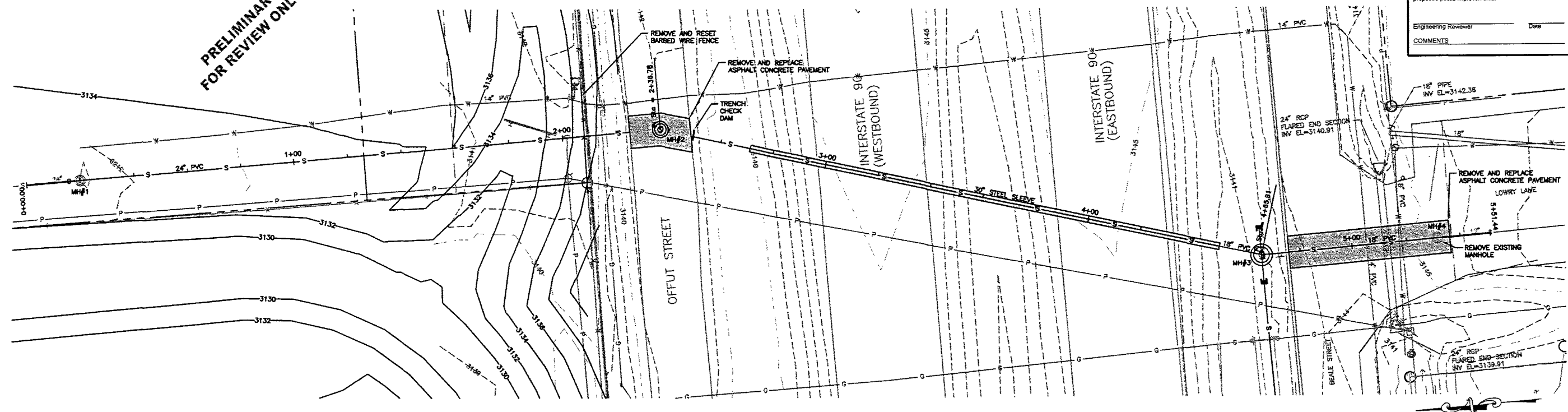

20' 10' 0' 20'

HORIZ. SCALE: 1" = 20'
 VERT. SCALE: 1" = 5'

Scale:	AS NOTED
Designed By:	STO/MDS
Drawn By:	MDS
Design Date:	1/07
Print Date:	1/07
Internal Job No.:	06-0437
Surveyed By:	FSK
Survey Date:	11/06
Revisions:	REV.1 - 02/06/07 CITY COMMENTS

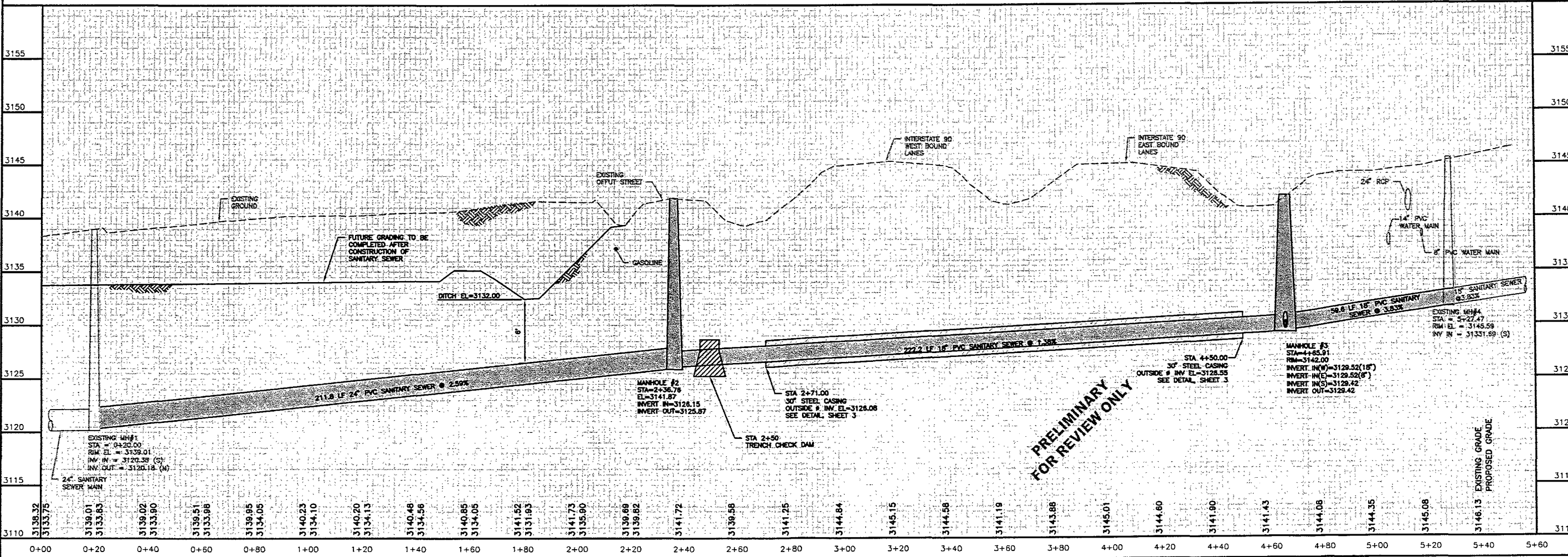

PRELIMINARY FOR REVIEW ONLY

**LOWRY LANE AND INTERSTATE 90
 SANITARY SEWER MAIN**

Sheet Title:
 18" SANITARY SEWER
 PLAN & PROFILE
 STA 0+00 TO 5+47.47