

CROOK DRIVE PLAN

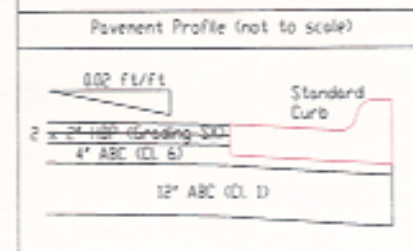

Typical Street Cross-Section for Creek Drive

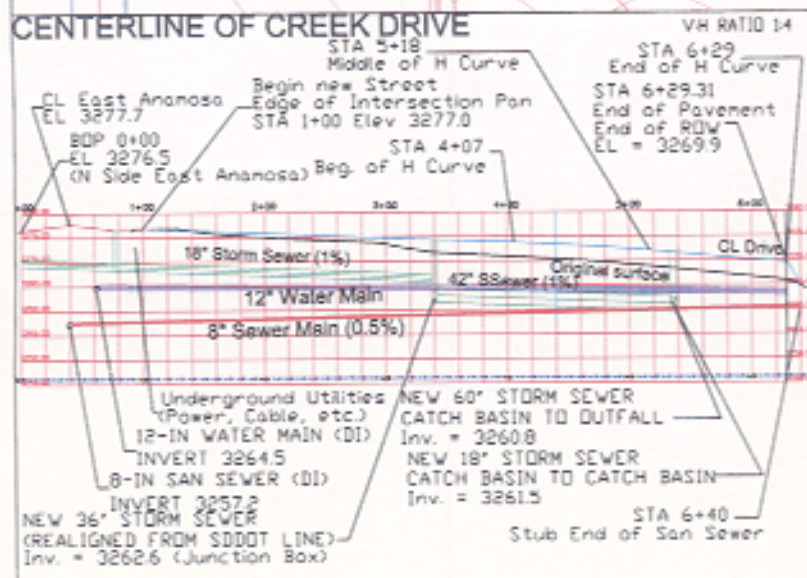
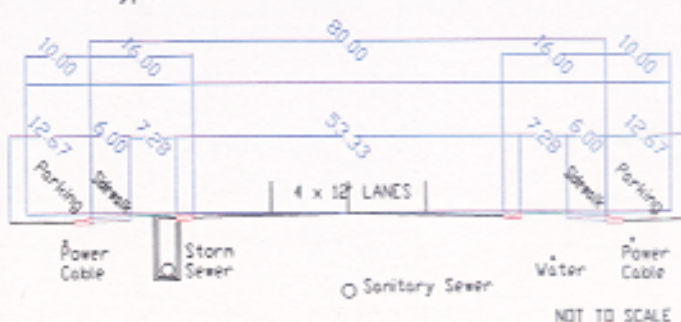

CURVE DATA FOR STREET CENTERLINE

From point of beginning (Sta 1+00)
 S 4500m00s W 418 ft
 Curve: R=280.0 ft, A=221.84 ft,
 D=22d40m36s
 End of curve Sta 5+18

Future S00d00m00s W to Philadelphia Street

SIDEWALKS AND CROSS WALKS

6-foot wide concrete sidewalks located at property line on each side of full length of street, as shown. Crosswalks located at Sta 1+00 and 5+00.

Sidewalks and crosswalks to be constructed per current City Standards.

Preliminary Plat of
 LOT 3 of BLOCK 2,
 MENARD SUBDIVISION

CREEK DRIVE
 PLAN & PROFILE
 (North Portion)

80-foot Right of Way
 10-foot easement both sides
 1-foot contour interval
 Based on extension of Creek Drive
 south to Philadelphia Street
 Designed for 30 mph

Existing Contours
 Proposed Contours

- 1+00 Begin new Creek Drive
Street slope 1% to SW
CL 545.0dW for 418'
- 4+07 Begin curve R=280'
Curve A=45d/221.84'
- 5+00 Begin vertical curve
- 5+18 Middle of horizontal curve
Street slope 2% to South
Road width: 48' (4 x 12' lanes)
with std 2'8" curb & gutter
Prop Line Sidewalks 6' wide
Parking in 10' easement, both sides
No parking in street

See Also Profile Drawing.

Prepared by N. Barton, 4 DEC 04

RECEIVED

DEC 10 2004

Rapid City Growth
Management Department

PROJECT NO: WL-5000-04C
 PROJECT NO: DW-103-133
 FILE NAME: CrogDriveAPCD.dwg-11/11
 DATE: 4 DEC 2004