

ELEVATIONS ESTIMATED FROM USGS MAP AND SURVEY BY ALLIANCE (4/97).

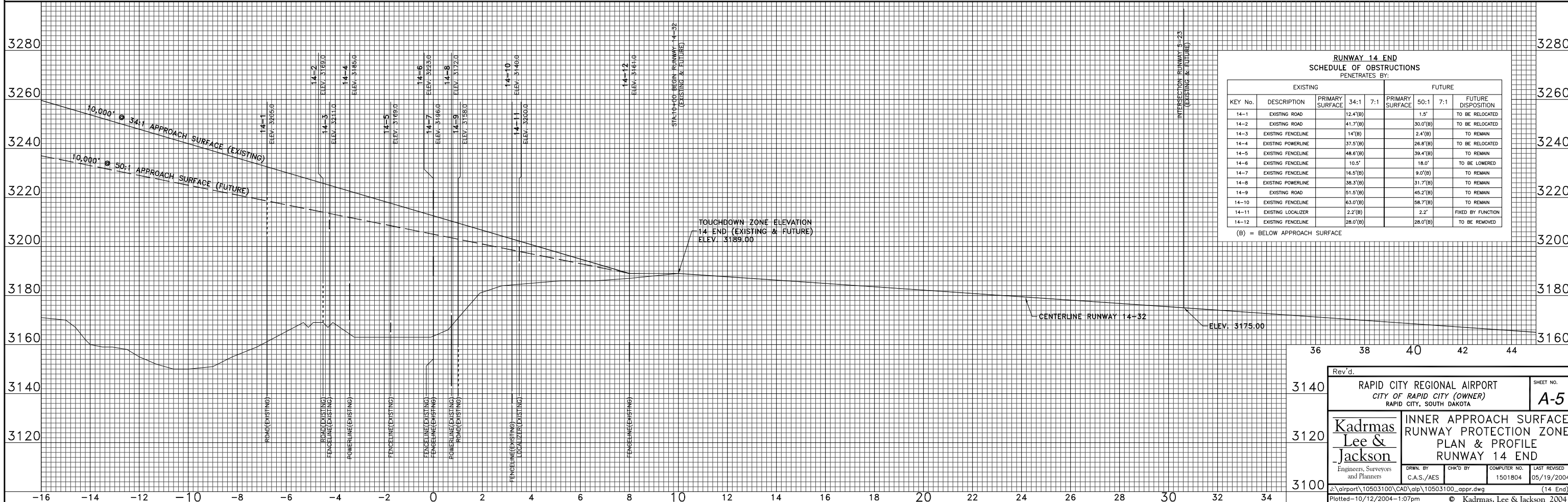
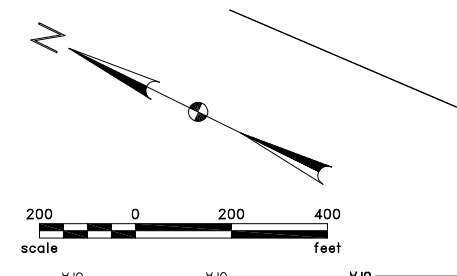

**RUNWAY 14 END
SCHEDULE OF OBSTRUCTIONS
PENETRATES BY:**

| KEY No. | DESCRIPTION | EXISTING | | FUTURE | | FUTURE DISPOSITION |
|---------|--------------------|-----------------|----------|-----------------|----------|--------------------|
| | | PRIMARY SURFACE | 34:1 7:1 | PRIMARY SURFACE | 50:1 7:1 | |
| 14-1 | EXISTING ROAD | 12.4'(B) | | 1.5' | | TO BE RELOCATED |
| 14-2 | EXISTING ROAD | 41.7'(B) | | 30.0'(B) | | TO BE RELOCATED |
| 14-3 | EXISTING FENCELINE | 14'(B) | | 2.4'(B) | | TO REMAIN |
| 14-4 | EXISTING POWERLINE | 37.5'(B) | | 26.8'(B) | | TO BE RELOCATED |
| 14-5 | EXISTING FENCELINE | 48.8'(B) | | 39.4'(B) | | TO REMAIN |
| 14-6 | EXISTING FENCELINE | 10.5' | | 18.0' | | TO BE LOWERED |
| 14-7 | EXISTING FENCELINE | 16.5'(B) | | 9.0'(B) | | TO REMAIN |
| 14-8 | EXISTING POWERLINE | 38.3'(B) | | 31.7'(B) | | TO REMAIN |
| 14-9 | EXISTING ROAD | 51.5'(B) | | 45.2'(B) | | TO REMAIN |
| 14-10 | EXISTING FENCELINE | 63.0'(B) | | 58.7'(B) | | TO REMAIN |
| 14-11 | EXISTING LOCALIZER | 2.2'(B) | | 2.2' | | FIXED BY FUNCTION |
| 14-12 | EXISTING FENCELINE | 28.0'(B) | | 28.0'(B) | | TO BE REMOVED |

(B) = BELOW APPROACH SURFACE

Rev'd.

RAPID CITY REGIONAL AIRPORT
CITY OF RAPID CITY (OWNER)
RAPID CITY, SOUTH DAKOTA

SHEET NO.
A-5

Kadmas Lee & Jackson
Engineers, Surveyors and Planners

**INNER APPROACH SURFACE
RUNWAY PROTECTION ZONE
PLAN & PROFILE
RUNWAY 14 END**

| | | | |
|------------------------|----------|-------------------------|----------------------------|
| DRWN. BY C.A.S./AES | CHK'D BY | COMPUTER NO. 1501804 | LAST REVISED 05/19/2004 |
|------------------------|----------|-------------------------|----------------------------|

J:\airport\10503100\CAD\alp\10503100_appr.dwg (14 End)
Plotted-10/12/2004-1:07pm © Kadmas, Lee & Jackson 2004