

04VE012

Exhibit "A"

Vacation of a portion of the Utility Easement in Lot 4 of Steele Subdivision

Located in NW¼ SE¼ and NE¼ SE¼ of Section 9, T1N, R7E, BHM, Rapid City, Pennington County, South Dakota

Evergreen Drive

Evergreen

R=55.0'
C=63.10'

S 70°34'07" E - 106.87' - measured

N 54°47'56" W - 55.12'

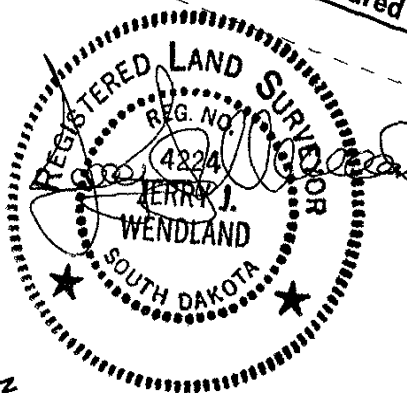

Portion of Utility Easement to be Vacated

N 18°29'51" W - 84.33'

N 0°27'32" W - 190.02' - record

90.00'

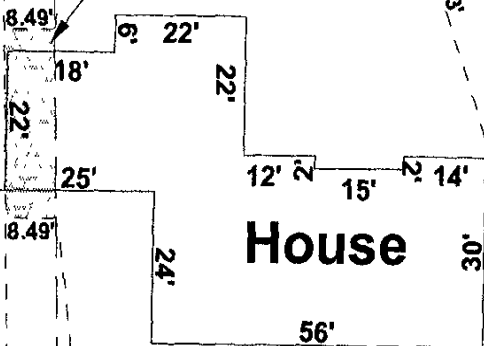

S 0°19'18" W - 191.00' - calculated

N 0°03'45" W - 81.75'

72.74'

16.49'

8' utility & minor drainage easement

S 89°52'45" W

S 89°56'15" W - 133.02' - record

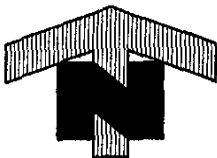

1"=30'

Prepared by:
Angle Surveys
Jerry Wendland
6909 Ridgeview Dr.
Black Hawk, SD 57718

May 3, 2004