

JERRY J. WENDLAND
 LAND SURVEYING
 6909 Ridgeview Dr.
 Black Hawk, SD
 57718-9555
 Tele: 605-787-4503 / Fax: 605-787-9454

ANGLE SURVEYS

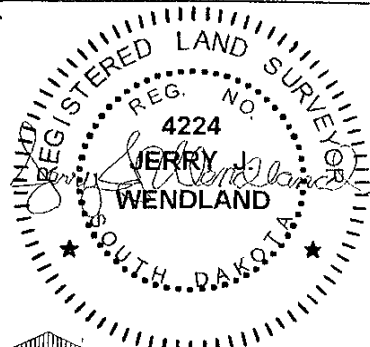

I, Jerry J. Wendland, Registered Land Surveyor #4224 in the State of South Dakota, do hereby certify that this drawing and the survey thereof were performed by me and that the location of the major improvements to the property are shown to the accuracy needed to satisfy the needs of a title company, mortgage company, and/or lender, and that any encroachments, in evidence or known to me, onto other properties, or any encroachments of other properties onto this property, if any, are so noted or shown hereon. Dated this 30th day of April 2004.



Legal Description:
 Lot 3, of Steele Subd.
 Rapid City, Pennington
 County, South Dakota

Buyer:
 Leo & Kara Flynn
 2932 Evergreen Drive
 Rapid City, SD 57702



1"=30'

