

# Skyline Pines East Proposed Tract Balance Rezone Exhibit

## KEY:

-  CURRENTLY PARK FOREST
-  CURRENTLY LDR
-  CURRENTLY GENERAL COMMERCIAL
-  CURRENTLY GENERAL COMMERCIAL
-  CURRENTLY MDR
-  PROPOSED (GENERAL) COMMERCIAL
-  PROPOSED LDRS RESIDENTIAL
-  PROPOSED OFFICE COMMERCIAL
- ① AREA TO BE REZONED FROM PARK FOREST TO OFFICE COMMERCIAL
- ② AREA TO BE REZONED FROM PARK FOREST TO LDRS
- ③ AREA TO BE REZONED FROM LDR TO OFFICE COMMERCIAL
- ④ AREA TO BE REZONED FROM LDR TO OFFICE COMMERCIAL
- ⑤ AREA TO BE REZONED FROM MDR TO LDRS
- ⑥ AREA TO BE REZONED FROM MDR TO OFFICE COMMERCIAL
- ⑦ AREA TO BE REZONED FROM (GENERAL) COMMERCIAL TO OFFICE COMMERCIAL
- ⑧ AREA TO BE REZONED FROM MDR TO GENERAL COMMERCIAL
- ⑨ AREA TO BE REZONED FROM OFFICE COMMERCIAL TO (GENERAL) COMMERCIAL

Wynn  
Associates, Inc.  
Civil/Urban Planning  
Planning & Architecture  
2700 W. 10th St., Suite 100  
Tulsa, Oklahoma 74107  
Tel: 918.438.1111 Fax: 918.438.1112  
www.wynnassociates.com



April 8, 2006

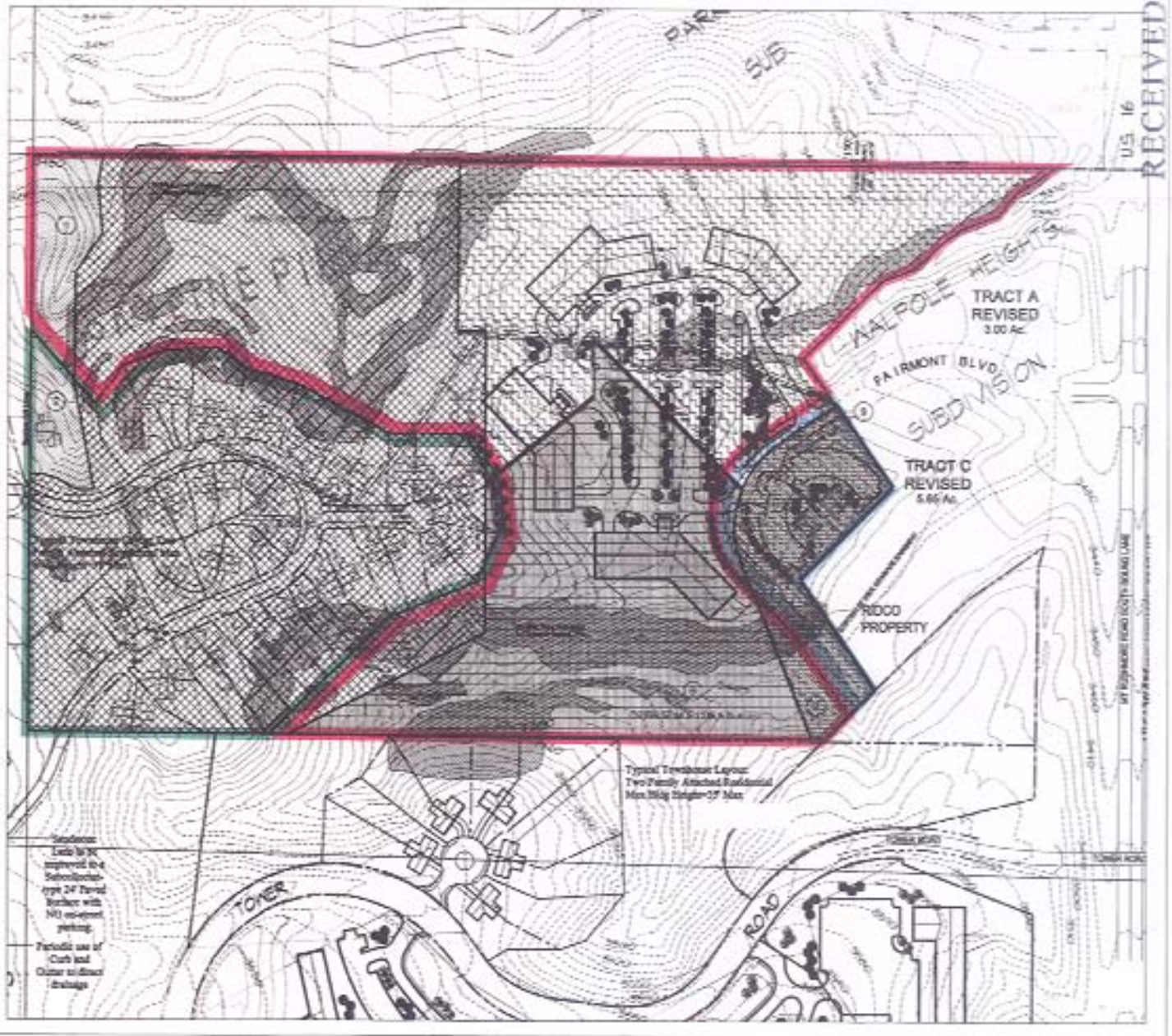

APR 16 2006