

NE 1/4 NW 1/4 NW 1/4 CL 1
 Section 18 T11N R6E
 10 Acres 4/4
 LAZYP-F-6 LAND COMPANY, INC.
 805 E. CATERER BLVD.
 RAPID CITY, SD 57701
 605.391.2027

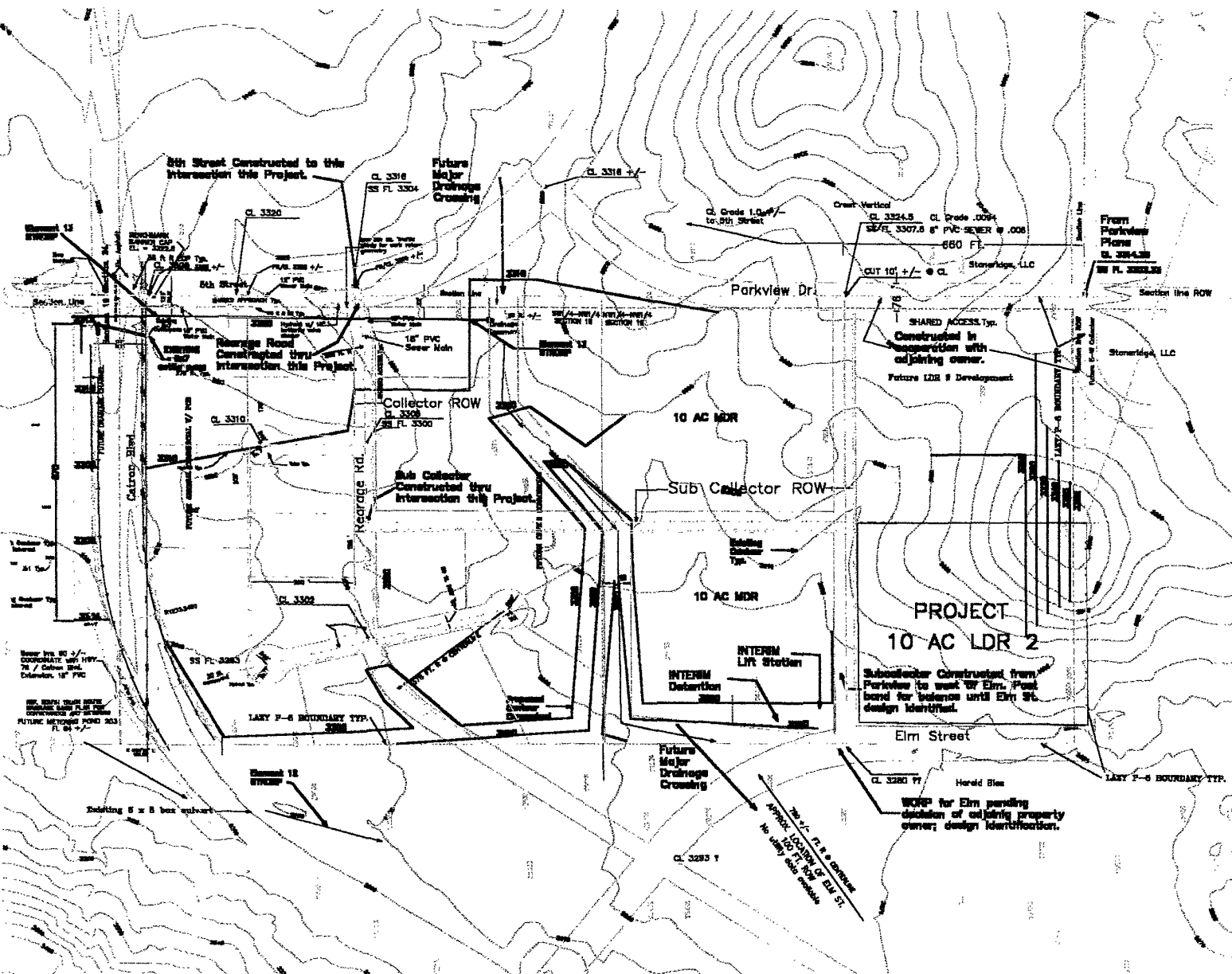
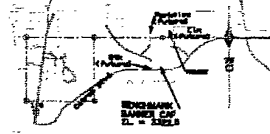

Legend

Centerline	---
Property Line	---
Water Line	---
Sanitary Sewer	---
Water Main	---
Storm Sewer	---
Gas Line	---
Electric	---
Telephone	---
City Lot	---
Subdiv. Block	---

NOTES REGARDING 5TH STREET
 Build proposed concrete road and utilities per City plans thru intersection with Rearage Road, this project.

NOTES REGARDING ROW
 Local, Sub Collector and Collector easements shown constructed to provide around access to Catran Blvd. this project.
 Others per City Major Street Plan.

WCRP requested for future Elm St. segment pending decision by adjoining owner; design identification.

NOTES REGARDING UTILITIES
 Water and sewer mains shown anticipate City connection to existing mains off site to be extended with Parkview Dr and Hwy 78 sewer extension projects.
 Interim LVR Station anticipated.

Interim water and sewer 8" minimum.
 (8" min. water in cut 66" soon with approved design).

REFERENCE:
 SOUTH TRUCK ROUTE DRAINAGE BASIN PLAN
 5TH STREET DESIGN PLANS
 UTILITY MASTER PLANS (REV.)

PRELIMINARY: NOT FOR CONSTRUCTION
LAYOUT PLAN

REVIEWED BY CITY ENGINEERING DIVISION	
Working	_____
Revised/Amended	_____
Checked	_____
Noted	_____
Comments	_____
_____	_____
_____	_____

Contractors shall be responsible for obtaining all necessary permits from the City Engineering Division before starting any of the proposed public improvements.

Contractors shall verify all data shown to be supplemented with field survey of critical locations, areas of final design.