

PROPOSED VACATION OF
SOUTH 1/2 OF THE SECTION
LINE R.O.W THAT IS LOCATED
ALONG THE NORTH SIDE OF
THE NE 1/4 OF SECTION 28,
T2N, R8E

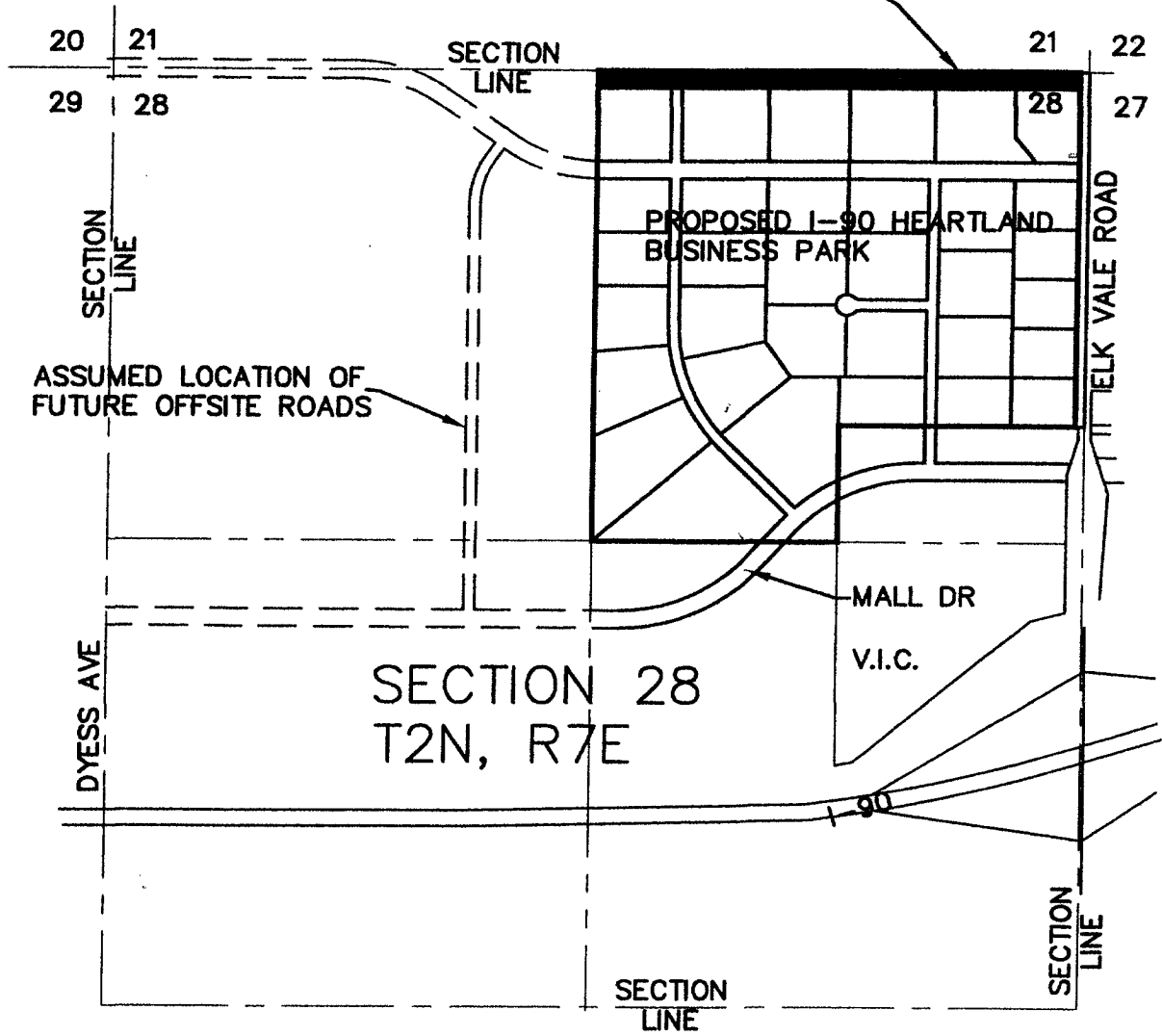

I:\land\Projects\2800\Title\2800\mstplintrev.dwg 07/10/2003 09:17:00 P.M. HP Line.plt 1:1

I-90 HEARTLAND BUSINESS PARK
RAPID CITY, SOUTH DAKOTA

JUNE 2003

Sheet Title:
**RIGHT OF WAY
VACATION**

Location:
**NE 1/4, SEC. 28
T2N, R8E, B1M**

Surveyed By: **FMG**
Date: **1/03-3/03**

Designed By: **RF**
Drawn By: **RK**
Checked By: **RF**

File Number:
0592



F M G, Inc.

3700 Sturgis Road
Rapid City, SD 57702-0317
(605) 342-4105 FAX (605) 342-4222

Sheet
Number

1

Total
Sheets:

1

03VR006

SCALE: 1"=1200'

PROPOSED SECTION
LINE R.O.W. VACATION

PROPOSED I-90
BUSINESS PARK

DYESS AVE

ELK VALLE ROAD

V.I.C.

I-90

I-90 HEARTLAND BUSINESS PARK
RAPID CITY, SOUTH DAKOTA

Sheet Title:
VICINITY MAP

Location:
NE 1/4, SEC. 29
T2N, R8E, B1M

JUNE 2003

Surveyed By: **FMG**
Date: **1/03-3/03**

Designed By: **JDF**
Drawn By: **JRK**
Checked By: **JDF**

File Number:
0000



F M G, Inc.

3700 Sturgis Road
Rapid City, SD 57702-0317
(605) 342-4105 FAX (605) 342-4222

Sheet
Number: **1**
Total
Sheets: **1**