

Plat of Lot 1 and Lot 2 of Tract A of Walpole Addition

01PL070

Prepared by:
FMG Engineering
3700 Sturgis Road
Rapid City, SD 57702
605/342-4105

formerly Tract A of Walpole Addition
located in SW1/4 of Section 12, T1N, R7E, BHM,
Rapid City, Pennington County, South Dakota.

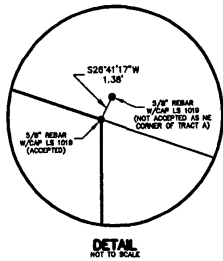

TRACT AR-1

LOT 1 (3.552 Ac.)

LOT 2 (1.452 Ac.)

TRACT AR-6

NOTES

- Denotes set 5/8" rebar with survey cap marked "FMG Inc. LS SD 6119".
● Denotes Found Survey Monument.
(R) Denotes Recorded previous plat or description.
(M) Denotes Measured in the survey.
(C) Denotes Calculated.
Basis of Bearings: As shown hereon.
Building setback requirements are as stated in the zoning and/or platting regulations.
Utility and Minor Drainage Easements: 8' on the interior sides of all lot lines.
Any major drainage easement shown hereon shall be kept free of all obstructions including but not limited to buildings, walls, fences, hedges, trees and shrubs. These easements grant to all public authorities the right to construct, operate, maintain, inspect, and repair such improvements and structures as it deems expedient to facilitate drainage from any source.

CERTIFICATE OF SURVEY
State of South Dakota
County of Pennington S.S.

I, Derek J. Weidensee, Registered Land Surveyor No. 6119 of the State of South Dakota, do hereby certify that being so authorized, the survey and within plat of the land shown and described hereon were made under my responsible direction and supervision and that to the best of my knowledge and belief the within plat is a correct representation of said survey. All acre amounts shown on the within plat are to be considered as having the words "more or less" following due to mathematical "rounding".

In witness whereof, I have hereunto set my hand and seal.

Derek J. Weidensee, Registered Land Surveyor

CERTIFICATE OF OWNERSHIP
State of South Dakota
County of Pennington S.S.

We, the undersigned corporation and authorized corporate officer(s), do hereby certify that said corporation is the owner of the land described hereon, that the survey was done at our request for the purposes indicated hereon, and that we do hereby approve the survey and within plat of said land, and that development of this land shall conform to all existing applicable zoning, subdivision and erosion and sediment control regulations.

In witness whereof, I have hereunto set my hand and seal.

OWNER: BLACK HILLS REGIONAL EYE INSTITUTE

By: MARVIN TRUHE
SECRETARY OF BOARD OF DIRECTORS

On this ___ day of ___, 20___, before me, a Notary Public, personally appeared Marvin Truhe, known to me to be the Secretary of the Board of Directors of the corporation that is described in and that executed the within instrument and acknowledged to me that such corporation executed the same.

NOTARY PUBLIC:
My commission expires: ___

CERTIFICATE OF DIRECTOR OF EQUALIZATION

I, Director of Equalization of Pennington County, do hereby certify that I have on record in my office a copy of the within-described plat.

Dated this ___ day of ___, 20___.

Director of Equalization of Pennington County

APPROVED: ___
Director of Equalization of Pennington County

CERTIFICATE OF FINANCE OFFICER

I, Finance Officer of the City of Rapid City, do hereby certify that all special assessments which are liens upon the within-described lands are fully paid according to the records of my office.

Dated this ___ day of ___, 20___.

Finance Officer of the City of Rapid City

RESOLUTION BY GOVERNING BOARD
State of South Dakota
County of Pennington S.S.

I, Finance Officer of City of Rapid City, do hereby certify that at an official meeting held on ___, 20___, the Common Council, by resolution, did approve the plat as shown hereon.

Finance Officer of the City of Rapid City

CERTIFICATE OF HIGHWAY OR STREET AUTHORITY

The location of the proposed property lines with respect to the Highway or Street as shown hereon is hereby approved. Any approaches or access to the Highway or Street will require additional approval. Dated this ___ day of ___, 20___.

Highway or Street Authority

CERTIFICATE OF COUNTY TREASURER

I, Treasurer of Pennington County, do hereby certify that the taxes which are liens upon the within-described lands are fully paid according to the records of my office.

Dated this ___ day of ___, 20___.

Treasurer of Pennington County

CERTIFICATE OF REGISTER OF DEEDS
State of South Dakota
County of Pennington S.S.

Filed this ___ day of ___, 20___, at ___ o'clock ___ M. in Book ___ of Plats, Page ___.

Register of Deeds

RECEIVED
JUL 11 2001
Rapid City Planning Department