

SITE PLAN - LOT 2 OF LOT K2-C OF MARSHALL HEIGHTS TRACT

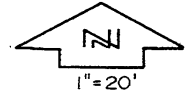
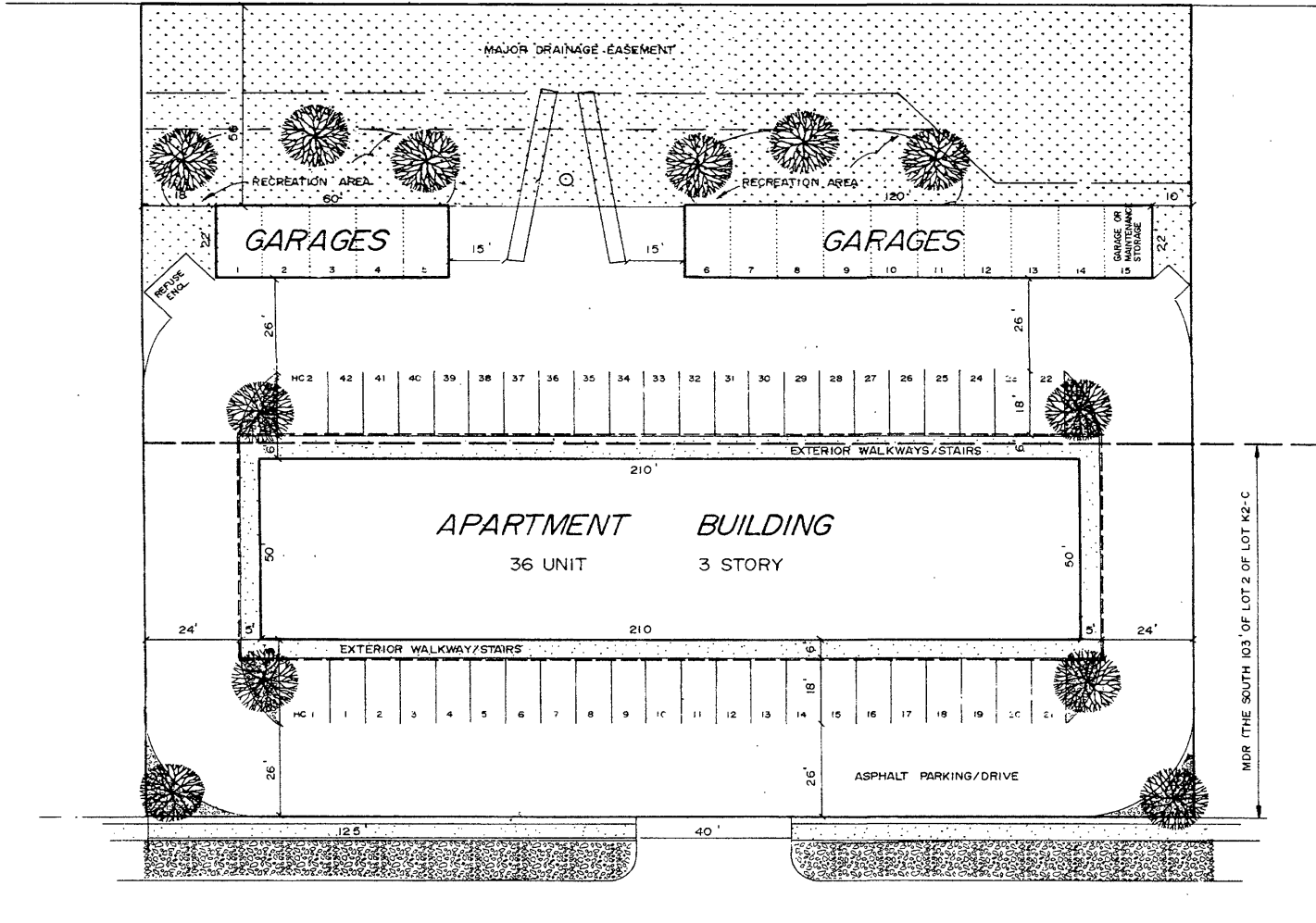

LANDSCAPE REQUIREMENTS

| | |
|----------------------------------|---------------|
| Total Lot Area | 60,418 |
| Less Building Area | -10,500 |
| Less Garage Area | - 3,960 |
| Total Required Points | 49,958 |
| Points Demonstrated | |
| Grass - 1,665 sy | 16,650 |
| Ground Cover - 300 sy | 30,000 |
| Small Trees - 12 | 6,000 |
| Total Points Demonstrated | 52,650 |

NOTE: Landscaping shown herein demonstrates the sites ability to support the required points. Specific planting materials and locations, which comply with the total point requirements shall be determined by the developer at the time of application for a building permit.

PARKING REQUIREMENTS

| | |
|-----------------------------------|-----------|
| Total Required Parking | |
| 36 units @ 1:5/unit | 54 |
| Parking Demonstrated | |
| Standard parking spaces | 42 |
| Handicap parking spaces | 2 |
| Garage units | 15 |
| Total Parking Demonstrated | 59 |

01PD032

KNOLLWOOD DRIVE