

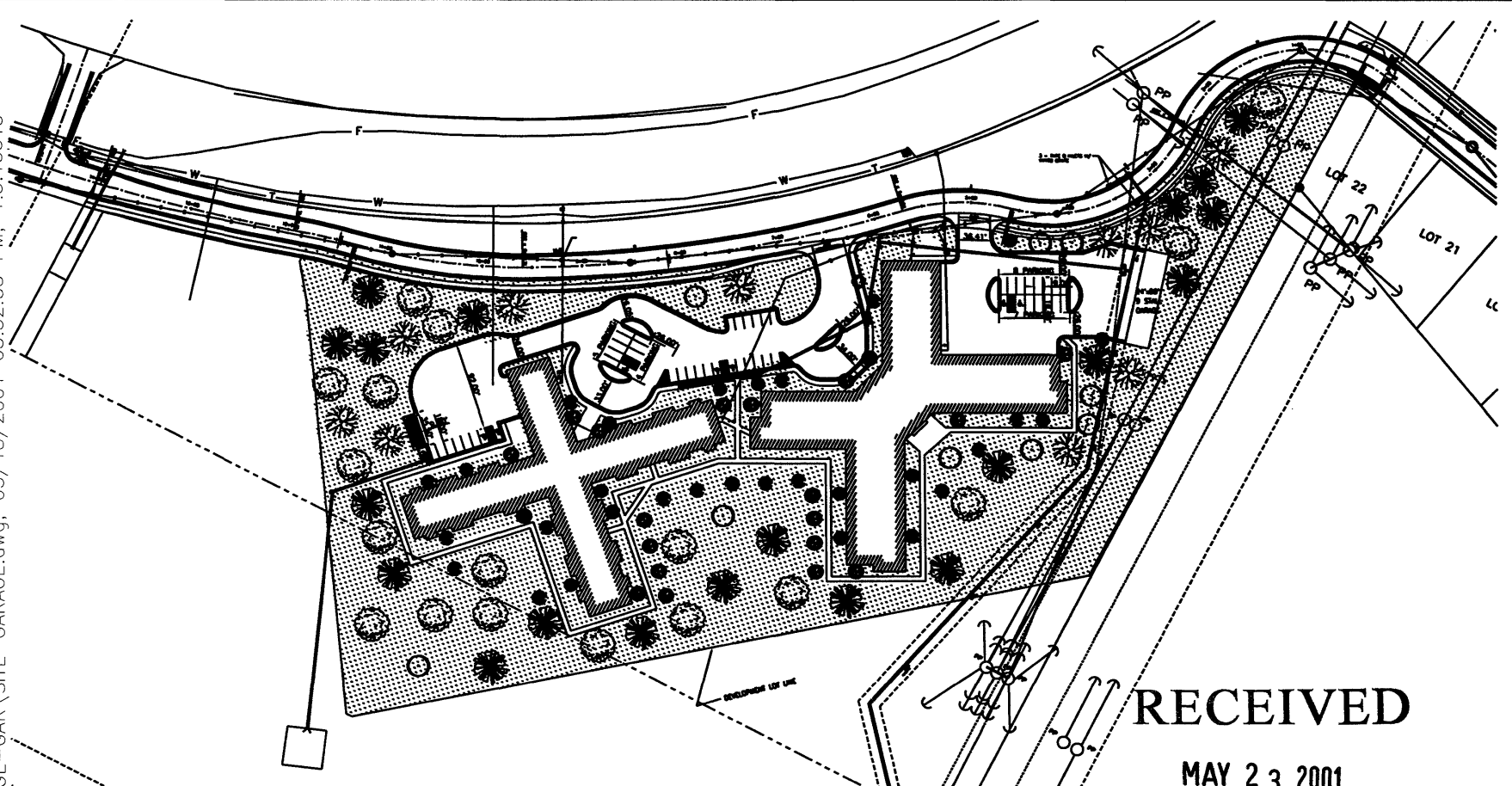







D:\T-PROJECTS\ECHO-RIDGE-GAR\SITE-GARAGE.dwg, 05/18/2001 03:52:55 PM, 1:3.153173



LANDSCAPE SCHEDULE

-  HICKORY = 30
-  MARSHALL'S ASH = 30
-  CRAB APPLE = 10
-  MAPLE = 10
-  SAWTOOTH OAK = 10
-  MUHLENBERG PINE = 10
-  DWARF KOREAN LILAC = 30
-  GRASS AREA

PARKING AND LANDSCAPING REQUIREMENTS:
PROPOSED BUILDINGS:
 USE: ASSISTED LIVING
 TOTAL PARKING REQUIRED = 433 SPACES
 PARKING PROVIDED: 48 SPACES

LANDSCAPING REQUIREMENTS:
 LOT AREA: 123,000 S.F.
 PROPOSED STRUCTURES: 60,300 S.F.
 LANDSCAPING REQUIRED: 262,791 POINTS
 70 LARGE TREES @ 2,000 = 140,000 POINTS
 30 MEDIUM TREES @ 1,000 = 30,000 POINTS
 GRASS: 10,277 S.F. @ 10 = 102,777 POINTS
 TOTAL LANDSCAPING PROVIDED: 270,577 POINTS

RECEIVED

MAY 23 2001

Rapid City
 Planning Department

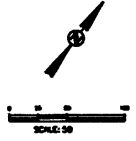

D.D.I.
DREAM DESIGN INTERNATIONAL, INC.
 PROFESSIONAL ARCHITECTURAL & CIVIL ENGINEERING CONSULTANTS
 1000 W. 10TH ST., SUITE 200, RAPID CITY, SD 57701
 TEL: 605-342-2222 FAX: 605-342-2223 EMAIL: rddi@dreamdesign.com

PROJECT NO.	01-0028
DATE	05/18/2001
DESIGNER	LANDSCAPE ARCHITECT
CHECKED BY	LANDSCAPE ARCHITECT
DATE	05/18/2001
SCALE	AS SHOWN

LAND SCAPING PLAN
 ECHO RIDGE SENIOR APARTMENTS
 GARAGE SITE