

NOTE:  
THERE IS ONE FIRE HYDRANT ON THE HIGH LEVEL SYSTEM LOCATED IN THE NORTHEAST CORNER OF THE INTERSECTION OF LACROSSE STREET AND EAST ANAMOSA STREET AND ONE FIRE HYDRANT ON THE LOW LEVEL SYSTEM IN THE SOUTHEAST CORNER.

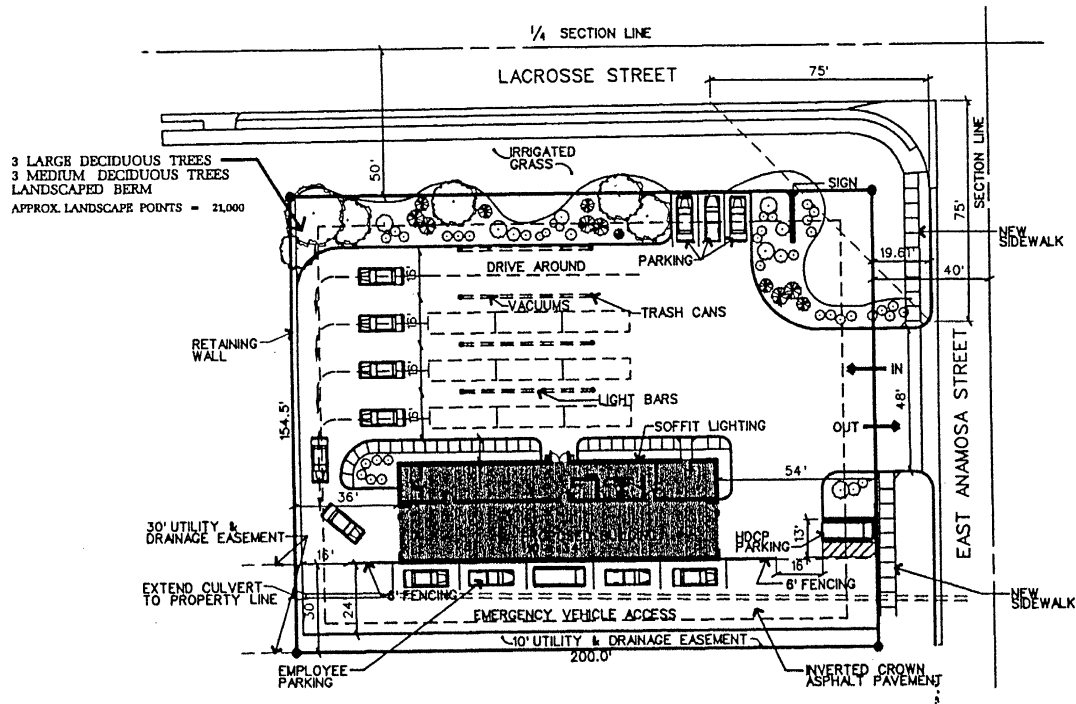

LANDSCAPE POINTS PROPOSED	
TREES, HEDGES, GROUND COVER	= 23,750
GRASS - IRRIGATED	= 2,838
GRASS - NON-IRRIGATED	= 1,387

TOTAL LANDSCAPE POINTS = 27,975  
(TOTAL POINTS REQUIRED = 27,100)



## PROPOSED SITE PLAN

LOT 9 OF LOT K-3 OF MARSHALL HEIGHTS TRACT,  
LOCATED IN THE SW¼ OF SECTION 30, T.2N., R.8E., B.H.M.  
RAPID CITY, PENNINGTON COUNTY, SOUTH DAKOTA

SCALE 1" = 20'

**PRELIMINARY**  
NOT FOR CONSTRUCTION