

# FREELAND MEADOWS SUBDIVISION

GOVERNMENT LOT 4 LESS ROW; UNPLATTED BALANCE OF SE1/4SW1/4;  
 UNPLATTED BALANCE OF S1/2SE1/4, SECTION 18,  
 T2N, R8E, B.H.M., PENNINGTON COUNTY, SOUTH DAKOTA

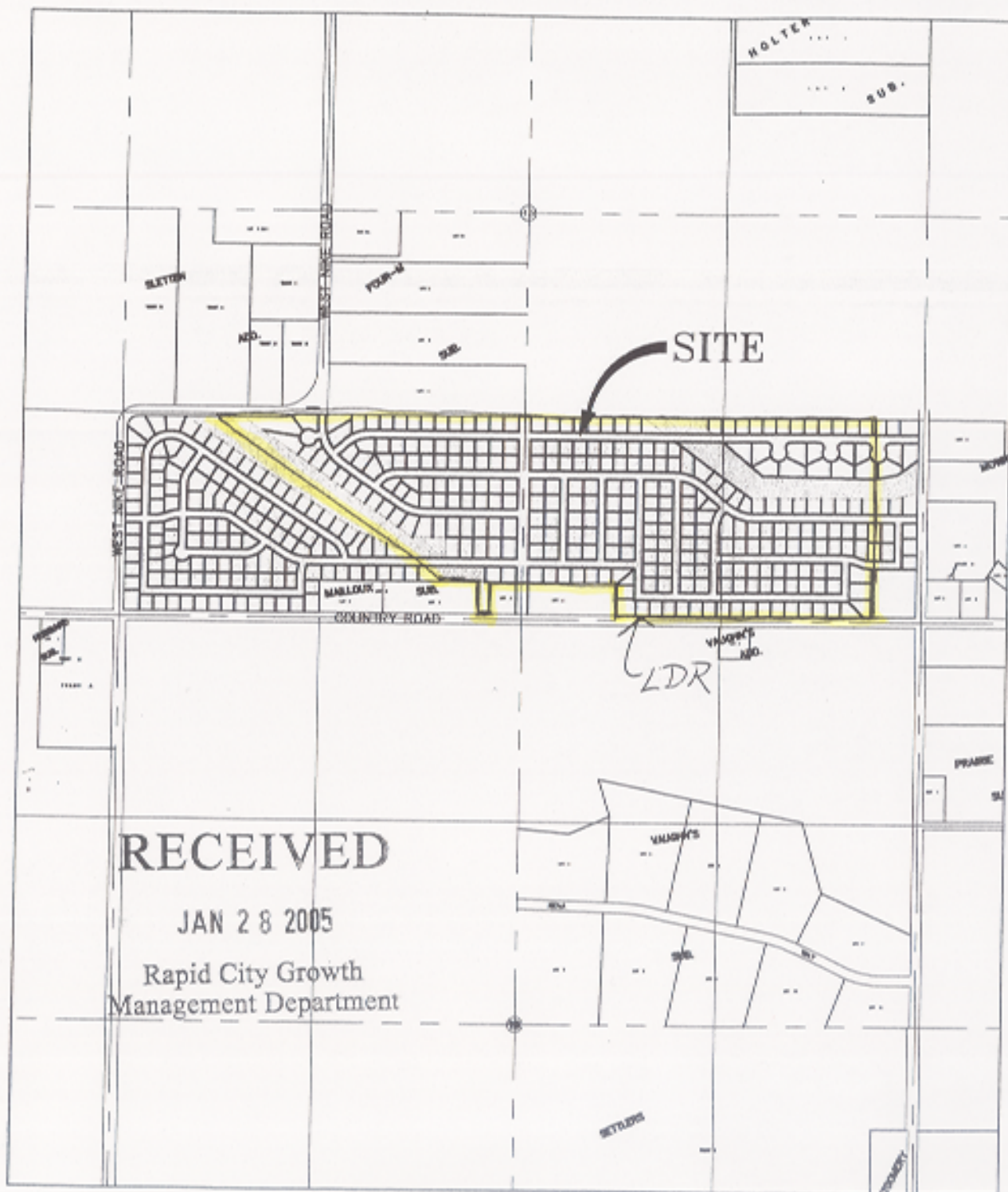

**RECEIVED**

JAN 28 2005

Rapid City Growth  
 Management Department

FREELAND MEADOWS

JOB NO: 05-0368	REV 1:
DATE: 01/28/05	REV 2:
DRAWN BY: RDC	REV 3:



**D.D.I.**  
**DREAM DESIGN INTERNATIONAL, INC.**  
 PROFESSIONAL STRUCTURAL & CIVIL ENGINEERING CONSULTANTS  
 608 KANSAS CITY ST., SUITE 4, RAPID CITY, SD 57101  
 PH. 605-345-0536 FAX. 605-345-0543 EMAIL: [engineers@dreamdesigninc.com](mailto:engineers@dreamdesigninc.com)