

05PL075

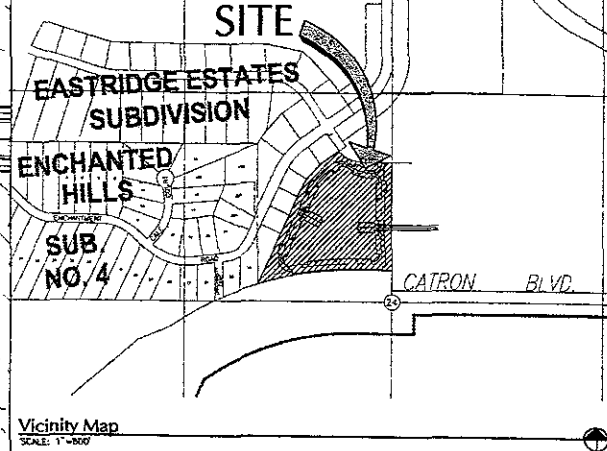
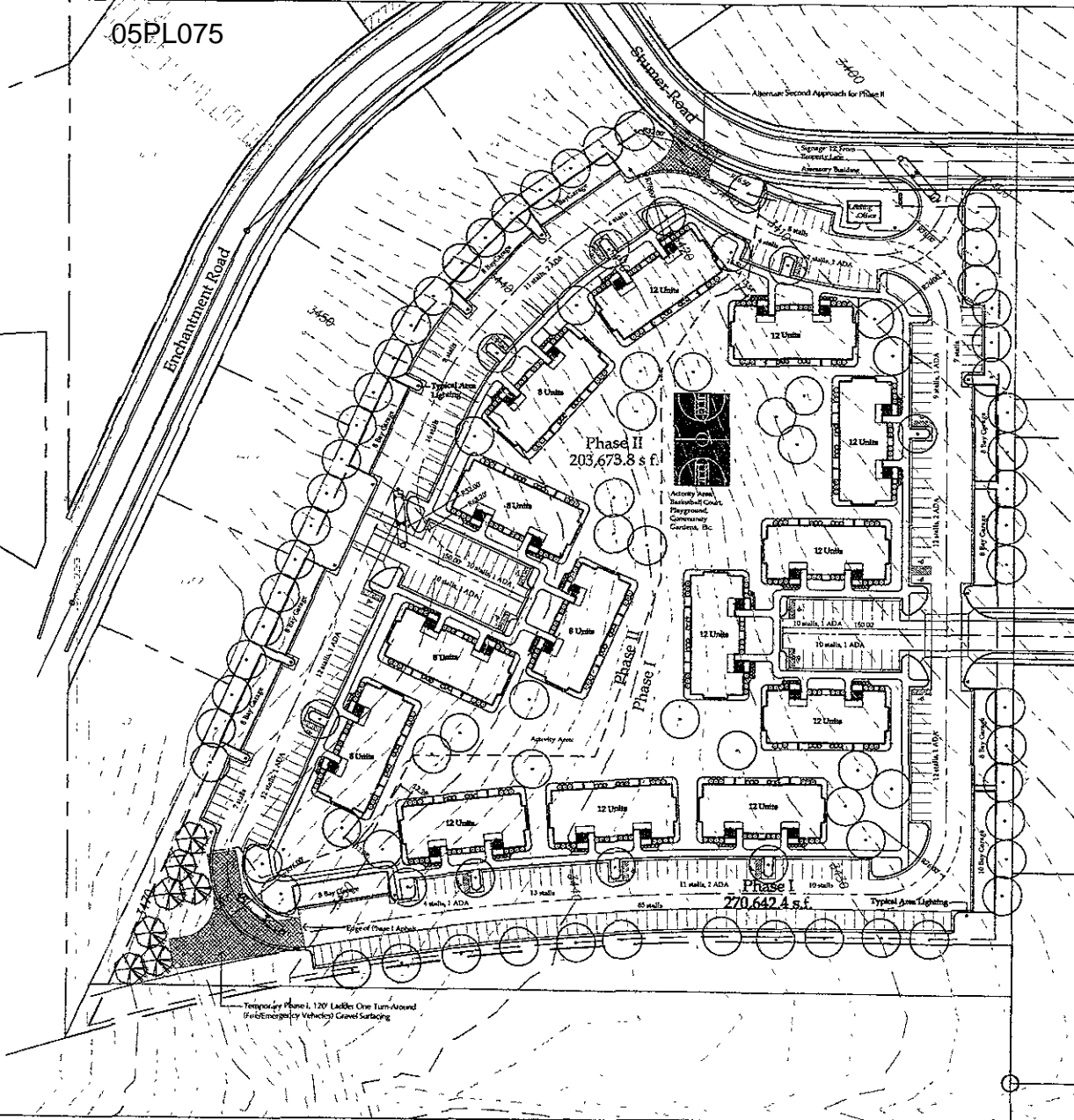

Site Information

Number of Units:
 5 - 8 Plex's
 9 - 12 Plex's

Parking Requirements:
 2 Open-Air Stalls per Unit -
 7 ADA Stalls Required
 296 Stalls Total Required

Parking Provided:
 288 Stalls Total
 16 ADA Stalls Provided
 82 Caraged Stalls Total (10 Garages)

Phase Information:
 Phase I 278,642.4 sq.ft.
 Phase II 203,673.8 sq.ft.

Site Coverage/Landscape Information

Apartment Units	
(14) 5276 Square Foot Units	73,864

Parking Garages	
(9) 1,760 Square Foot Units	15,840
(1) 2,200 Square Foot Unit	2,200

Total Site Area 10.9 Acres Total 474,316.2

Site Coverage Percentage 93,664 Structures/474,316.2 Site 20%

Landscape Points Required 474,316.2 (Site) - 93,664 (Structures) 380,652

Points Provided by Turfgrass 20,004 Square Yards Turf @ 10pts 200,040

Points Provided by Shade Trees 89 Total @ 2000 pts Per Tree 178,000

Points Provided by Groundcover 384 Square Yards @ 100pts 38,400

Total Landscape Points Provided 416,440

RECEIVED
 APR 15 2005
 Rapid City Growth
 Management Department

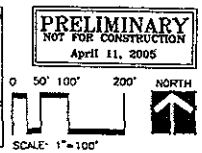

Wyss Associates, Inc.
 Landscape Architecture
 Civil/Concrete Architecture
 Field & Recreation Design
 728 5th Street - Rapid City, South Dakota 57101-3870
 Ph. 605.348.8588 Fax 605.348.6568
 www.wyssassociates.com

Black Hills Estates Eagle Ridge

Layout Plat

Project Name: Black Hills Estates Eagle Ridge
 Rapid City, South Dakota

NO.	REVISION	DATE

DESIGNED BY: EAH/MSH/PH
 DRAWN BY: AK
 APPROVED BY: PH
 PROJECT NO.: 05PH1
 DATE: April 11, 2005

Scale: 1" = 100'

Sheet: **LA1**
 1 of 1